



www.blauer-engel.de/uz140



StoTherm Classic® S1

First cement-free and non-combustible external wall insulation system

Non-combustible, highly impact-resistant, versatile in its use and the winner of several awards. Thanks to its innovative raw material technology, the StoTherm Classic® S1 EWI system does not only set the benchmark in fire protection. It has also just been awarded two renowned quality labels for its efficient insulating performance and functionality. Firstly, as the best product of 2013 with the "Plus X Award". StoTherm Classic® S1 also bears the well-known "Blue Angel" environmental seal for particularly environmentally friendly thermal protection.

StoTherm Classic® S1 external wall insulation system

Non-combustible external wall insulation system, cement-free with the highest shock resistance

As the oldest and most successful environmental seal worldwide, the "Blue Angel" is widely trusted among consumers. The "Blue Angel for Climate Protection" focuses on energy-efficient products that are particularly energy-saving and durable. As a complete system that has been awarded the "Blue Angel" (RAL-UZ 140), the StoTherm Classic® S1 external wall insulation system is a sustainable alternative when it comes to increased requirements for environmental protection.

System advantages

- Non-combustible
- Highly mechanically resistant
- Crack-proof thanks to an organic coating build-up
- Highly resistant to microorganisms (algae and fungi)
- Cement-free, ready-to-use system components
- Can be applied without intermediate coat and paint coat
- Fully-fledged, purely organic EWI system thanks to use of the extremely durable, non-combustible raw material basalt
- Highly weather-resistant
- Permeable to CO₂ and water vapour

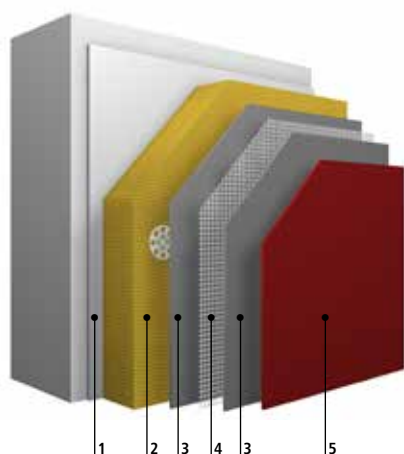

- 1 Adhesive**
Sto-ADH-B or StoLevell Uni
 - 2 Insulation**
Sto-Stone Wool Insulation Board
 - 3 Base coat**
StoArmat Classic® S1
 - 4 Reinforcement**
Sto-Glass Fibre Mesh
- To meet the requirements of the "Blue Angel":**
- 6 Finish**
StoSilco® blue, optionally with a double paint coat of Lotusan®

Overview of StoTherm Classic® S1

Area of application	<ul style="list-style-type: none"> • New and existing buildings up to a height of 100 m • Especially suitable for high-rise buildings, public buildings, and special constructions • Suitable for passive house standard
Substrate	<ul style="list-style-type: none"> • Masonry, for example, brick, lime sandstone, porous concrete, fair-faced concrete and facing masonry • Concrete, concrete slab construction (three-layer concrete slabs) • Unevenness of up to 2 cm (on solid constructions)
Fixing	<ul style="list-style-type: none"> • Bonding • Bonding and dowelling • Mechanical fixing with Sto-Rotofix plus
Thermal protection	<ul style="list-style-type: none"> • insulation board made of mineral wool up to 300 mm
Reaction to fire	<ul style="list-style-type: none"> • Non-combustible, A2-s1, d0 in accordance with EN 13501-1
Impact resistance	<ul style="list-style-type: none"> • High mechanical resistance, up to 15 joules in standard system configuration • Up to 90 joules in high impact-resistant system configuration • Ball-impact resistant in accordance with DIN 18032-3
Other properties	<ul style="list-style-type: none"> • Lotus-Effect®- Technology optional • Anti-electrosmog optional
Design possibilities	<ul style="list-style-type: none"> • Silicone resin render in a stippled texture or as free-style textured render • StoDeco Profiles, StoDeco Rustications
Colour spectrum	<ul style="list-style-type: none"> • Tintable in accordance with the StoColor System • Light reflectance value < 15 % possible
Application	<ul style="list-style-type: none"> • Fully cement-free, ready-to-use system components • No intermediate coat required • Special protection against algae and fungus with double paint coat • Application by machine
Other notes	<ul style="list-style-type: none"> • System components of the "Blue Angel" environmental seal are listed in the certificates
Approvals/standards	<ul style="list-style-type: none"> • The relevant national approvals apply

Head office

Sto SE & Co. KGaA

Market Development

Ehrenbachstrasse 1
79780 Stuehlingen
Germany

Phone +49 7744 57-1131

Fax +49 7744 57-2428

infoservice@sto.com

www.sto.com



The detailed technical specifications and information on the products contained in the Technical Data Sheets and approvals must be observed.